

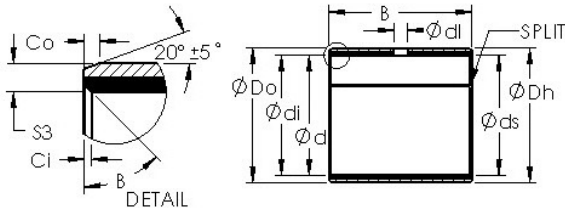

AD Bearing Machine Co., Ltd



AST AST11 9040 AST Bearing

Bearing No. AST11 9040

Bore Diameter	90 mm
Outer Diameter	95 mm
Bearing Type	straight
Shaft Dia., Nominal (d)	90.0000
Shaft Size (ds) - 90 -0 / -0.054	90 0 / 0.054
Housing Bore Dia. (Dh)	95 +0.035 / +0
Bearing Outside Diameter, Nominal(Do)	95.000
Bearing Outside Diameter Tolerance (Do tol.)	95.12 / 95.07
Bearing Bore after Mounting (di)	90.155 / 90.02
Average Clearance (Cd)	0.1150
Wall Thickness (S3)	2.490
Bearing Length, Nominal (B)	40.000
Bearing Length Tolerance (B tol.) - +0 / -0.40	+0 / 0.40
OD Chamfer Length (Co)	1.800
ID Chamfer Angle (B deg.)	45
ID Chamfer Length (Ci)	0.600
Material	Bronze shell with PTFE / Fiber lining

AST11 9040 Bearing 2D drawings and 3D CAD models