

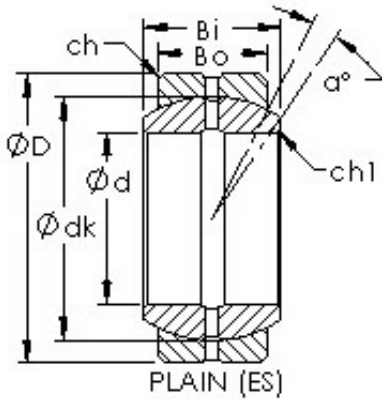

AD Bearing Machine Co., Ltd



AST GEG15ES AST Bearing

Bearing No. GEG15ES

Bore Diameter	15 mm
Outer Diameter	30 mm
Bearing Type	plain
Bore Dia (d)	15.0000
Outer Dia (D)	30.0000
Outer Width (Bo)	10.0000
Inner Width (Bi)	16.0000
Dynamic Load Rating (Cr)	21,000
Static Load Rating (Cor)	106,000
Max. shaft corner radius, or 45 deg. chamfer (ch1)	0.300
Max. housing corner radius, or 45 deg. chamfer (ch)	0.300
Spherical Diameter (dk or Dk)	25.000
Mis-alignment Angle (a deg.)	16
Weight (g)	48.00
Material	52100 Chrome steel, or equivalent

GEG15ES Bearing 2D drawings and 3D CAD models